

Standard Details

- C.1 Type A Handicapped Ramp
- C.2 Type A-M Handicapped Ramp
- C.3 Type B Handicapped Ramp
- C.4 Type C Handicapped Ramp
- C.5 Curb Profiles
- C.6 Curb Replacement Detail; Sidewalk Detail; Typical Street Cross Section; Handicap & Drive Curb Residential Detail
- C.7 Standard Driveway
- C.8 Standard Driveway with Sidewalk
- C.9 Street Trench

NOTE

NO ISOLATION JOINT MATERIAL between CURB & WALK OR LANDING.

ALL RAMPS TO SLOPE 1"/ft. MAX.

LENGTH OF RAMP TO BE 5'-0" MIN. 15'-0" MAX.

CROSS SLOPE OF ALL WALKS AND LANDINGS TO BE 2% MAX. (A.D.A.)

SLOPE OF ALL LANDINGS TO BE 2% MAX. IN ALL DIRECTIONS.

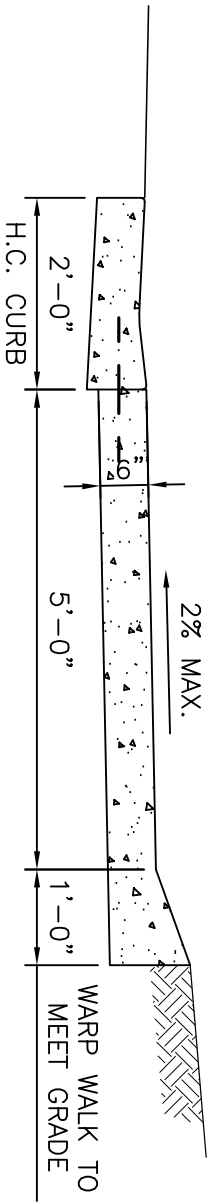

SECTION C-C

SCALE: 1/2" = 1'-0"

NOTE:

ALL BRICKS TO BE LAID PARALLEL TO WALK & RADIALY ON CURVES.

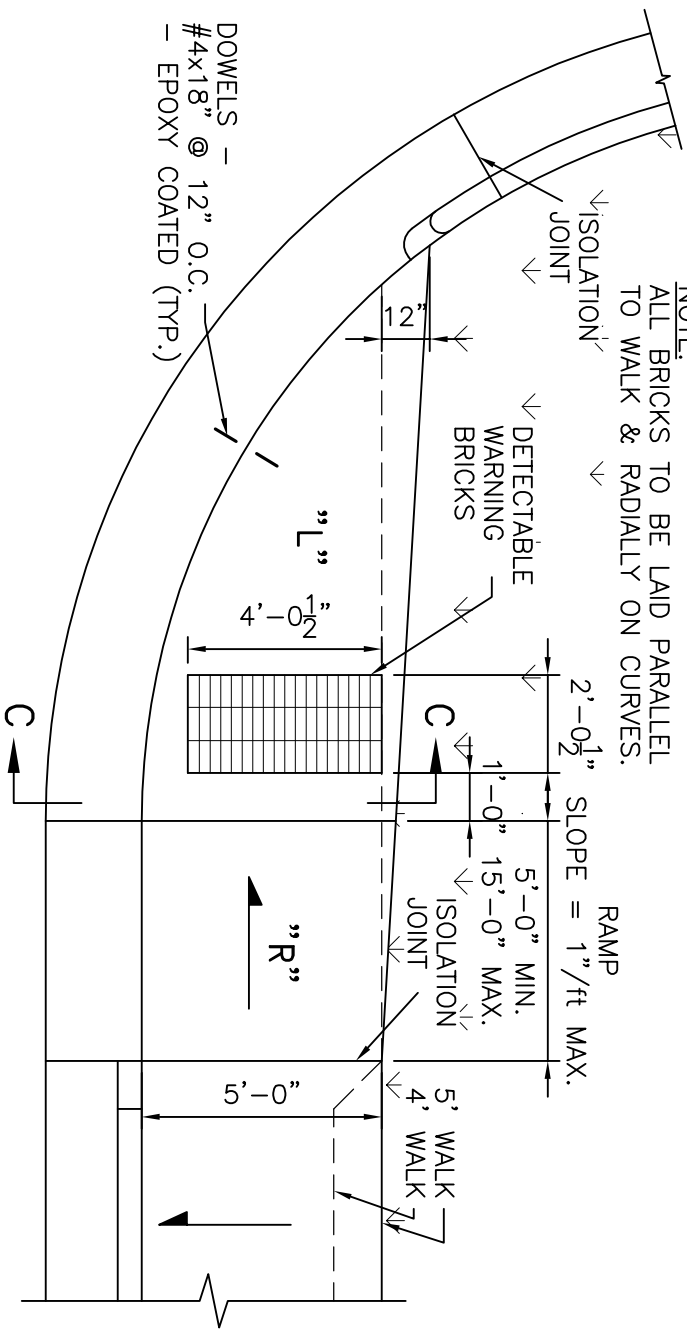

DOWELS - #4x18" @ 12" O.C. - EPOXY COATED (TYP.)

TYPE A-M H.C. RAMP

SCALE: 1/4" = 1'-0"

DATE: 10/06/06
 REVISIONS:
 ▲
 ▲
 ▲
 ▲



CITY OF WESTWOOD
 4700 Rainbow
 Westwood, Kansas 66205
 (913) 432-1550 - PUBLIC WORKS
 (913) 362-1550 - CITY HALL
 "THE BIGGEST LITTLE CITY IN KANSAS"

STANDARD DETAILS

PAGE NO.

C.2

© 2006

NOTE:
 REINFORCEMENT SHOWN IS FOR
 LOCATION & CLEARANCE – SEE
 SPECIFICATION FOR REINFORCEMENT
 REQUIREMENTS.

SAME AS RESIDENTIAL
 EXCEPT AS SHOWN

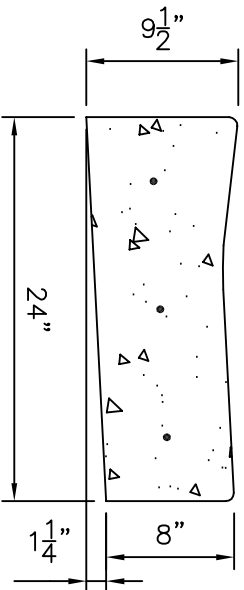

**COMMERCIAL
 DRIVE CURB**

SCALE: 1" = 1'-0"

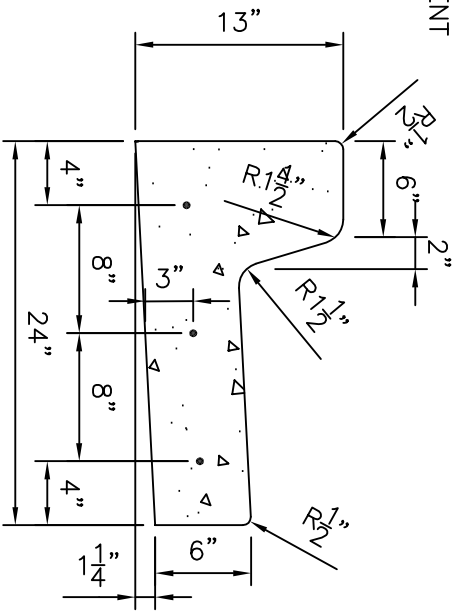

**VERTICAL CURB
 THROUGHFARES**

SCALE: 1" = 1'-0"

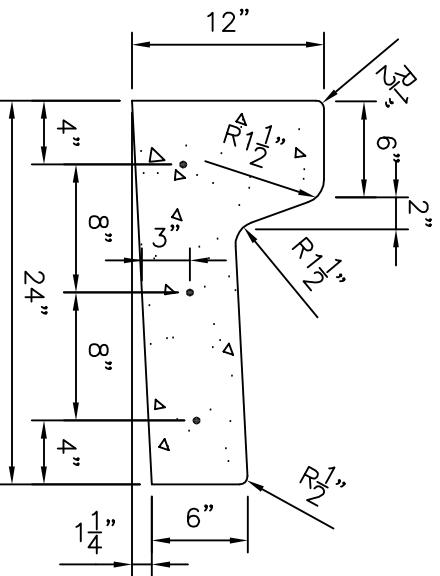

**VERTICAL CURB
 RESIDENTIAL**

SCALE: 1" = 1'-0"

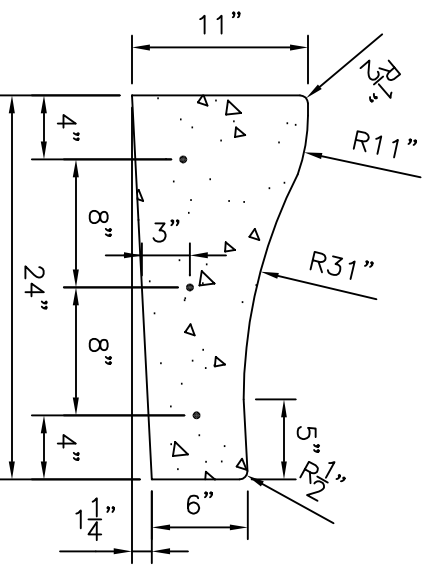

ROLLBACK CURB

SCALE: 1" = 1'-0"

DATE:
 10/06/06
 REVISIONS:
 ▲
 ▲
 ▲
 ▲



CITY OF WESTWOOD
 4700 Rainbow
 Westwood, Kansas 66205
 (913) 432-1550 - PUBLIC WORKS
 (913) 362-1550 - CITY HALL
 "THE BIGGEST LITTLE CITY IN KANSAS"

STANDARD DETAILS

PAGE NO.
C.5
 © 2006

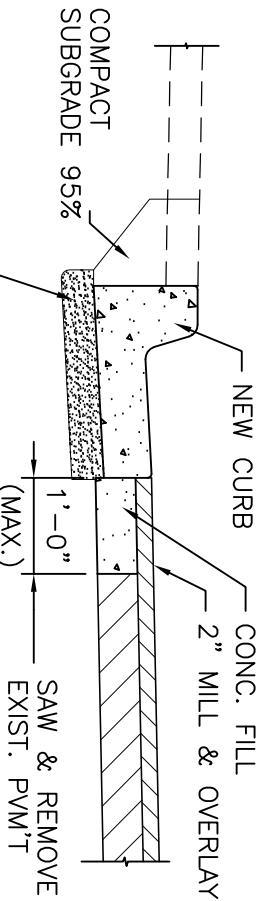

CURB REPLACEMENT DETAIL

SCALE: 1/2" = 1'-0"

1" DEEP CONTROL JT. SPACED SAME AS WALK WIDTH
 TOOL ALL 4 EDGES OF EACH PANEL
 4'-0"

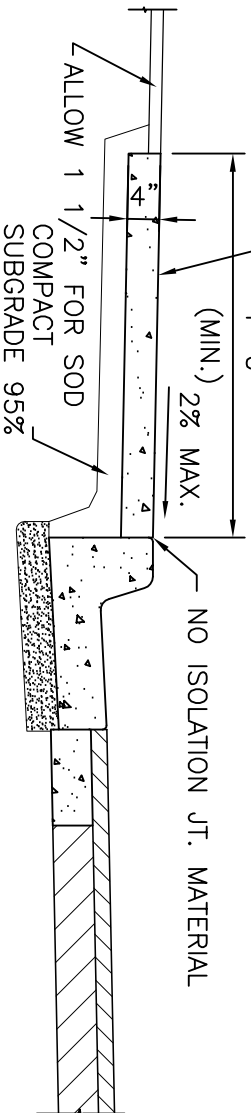

SIDEWALK DETAIL

SCALE: 1/2" = 1'-0"

SYMMETRICAL ABOUT ϕ

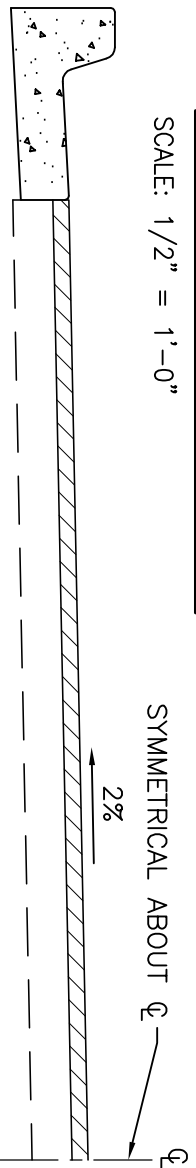

TYPICAL STREET CROSS SECTION

SCALE: 1/2" = 1'-0"

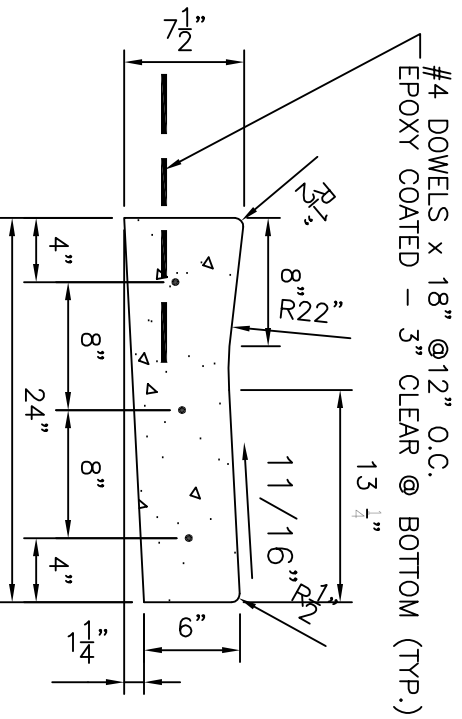

HANDICAP & DRIVE CURB RESIDENTIAL

SCALE: 1" = 1'-0"

DATE: 10/06/06
 REVISIONS:
 ▲
 ▲
 ▲
 ▲



CITY OF WESTWOOD
 4700 Rainbow
 Westwood, Kansas 66205
 (913) 432-1550 - PUBLIC WORKS
 (913) 362-1550 - CITY HALL
 "THE BIGGEST LITTLE CITY IN KANSAS"

STANDARD DETAILS

PAGE NO.

C.6

© 2006

NOTE:
 CURB JOINTS TO MATCH DRIVE JOINTS.
 NEW DRIVE MATERIAL & SURFACE SHALL
 MATCH EXISTING DRIVE.
 ASPHALT DRIVES SHALL HAVE 4" THICK
 BASE, APWA 1-01 OR 2-01.
 SURFACE COURSE SHALL BE APWA 3-01.
 REINF. DOWELS BETWEEN CURB & DRIVE
 SHALL BE #4x18" @ 12" O.C. - EPOXY
 COATED FOR ALL CONCRETE DRIVE
 APPROACHES.
 ALL TOOLED JOINTS SHALL BE TOOLED &
 SAWED TO A DEPTH OF 1/3 PAVEMENT
 THICKNESS.
 SLOPE OF ALL LANDINGS & DRIVE
 APPROACHES TO BE 2% MAX. IN ALL
 DIRECTIONS.

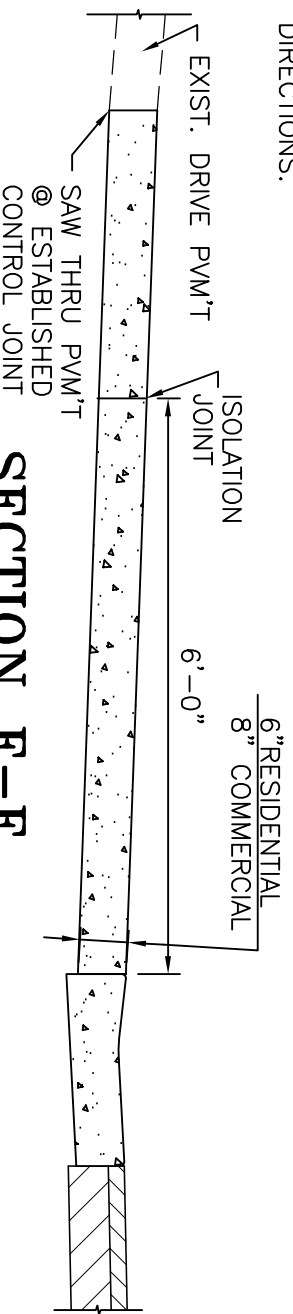

SECTION E-E

SCALE: 1/2" = 1'-0"

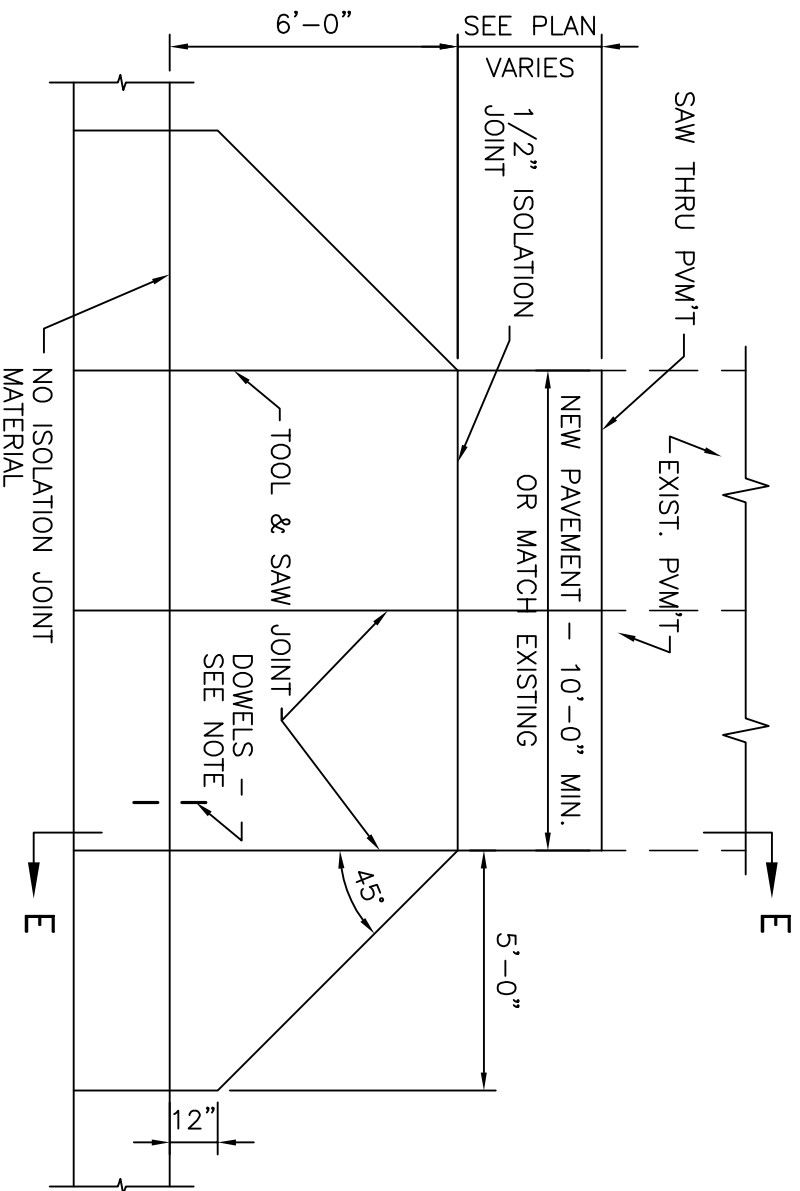

DRIVE

SCALE: 1/4" = 1'-0"

DATE:
10/06/06

REVISIONS:
 ▲
 ▲
 ▲
 ▲



CITY OF WESTWOOD
 4700 Rainbow
 Westwood, Kansas 66205
 (913) 432-1550 - PUBLIC WORKS
 (913) 362-1550 - CITY HALL
 "THE BIGGEST LITTLE CITY IN KANSAS"

STANDARD DETAILS

PAGE NO.
C.7

© 2006

NOTE:
 CURB JOINTS TO MATCH DRIVE JOINTS.
 NEW DRIVE MATERIAL & SURFACE SHALL MATCH EXISTING DRIVE.
 ASPHALT DRIVES SHALL HAVE 4" THICK BASE, APWA 1-01 OR 2-01.
 SURFACE COURSE SHALL BE APWA 3-01. REINF. DOWELS BETWEEN CURB & DRIVE SHALL BE #4x18" @ 12" O.C. - EPOXY COATED FOR ALL CONCRETE DRIVE APPROACHES.
 ALL TOOLED JOINTS SHALL BE TOOLED & SAWED TO A DEPTH OF 1/3 PAVEMENT THICKNESS.
 SLOPE OF ALL LANDINGS & DRIVE APPROACHES TO BE 2% MAX. IN ALL DIRECTIONS.

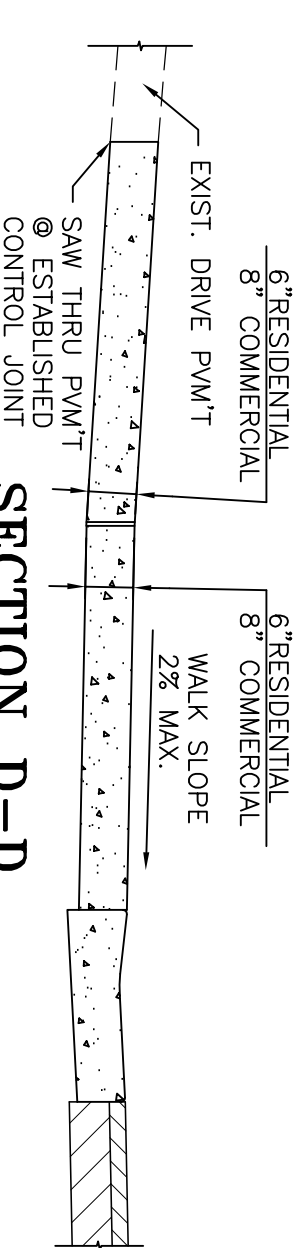

SCALE: 1/2" = 1'-0"

SECTION D-D

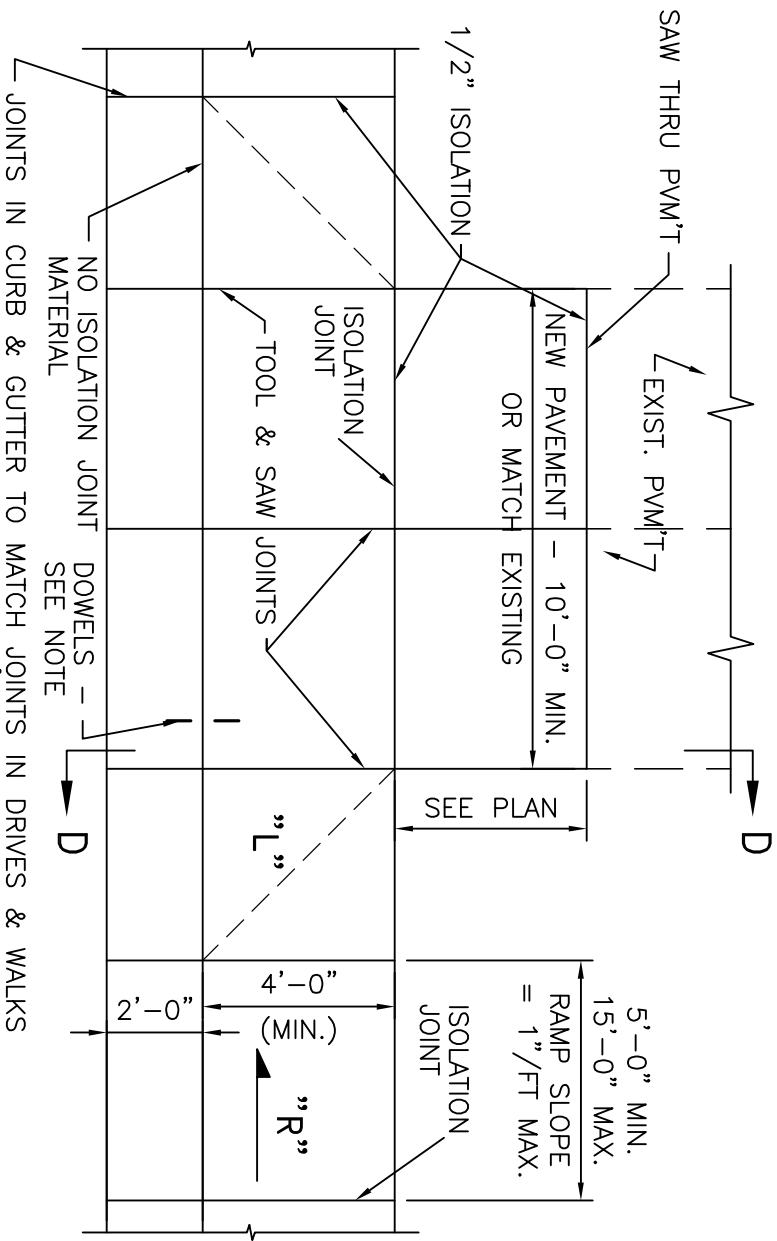

SCALE: 1/4" = 1'-0"

DRIVE W/ WALK

DATE: 10/06/06
 REVISIONS:
 ▲
 ▲
 ▲
 ▲



CITY OF WESTWOOD
 4700 Rainbow
 Westwood, Kansas 66205
 (913) 432-1550 - PUBLIC WORKS
 (913) 362-1550 - CITY HALL
 "THE BIGGEST LITTLE CITY IN KANSAS"

STANDARD DETAILS

PAGE NO.
C.8
 © 2006

2nd SAW CUT - AFTER BACKFILL IS MADE.
 12" BEYOND WIDEST AREA OF TRENCH
 & AT EACH END.

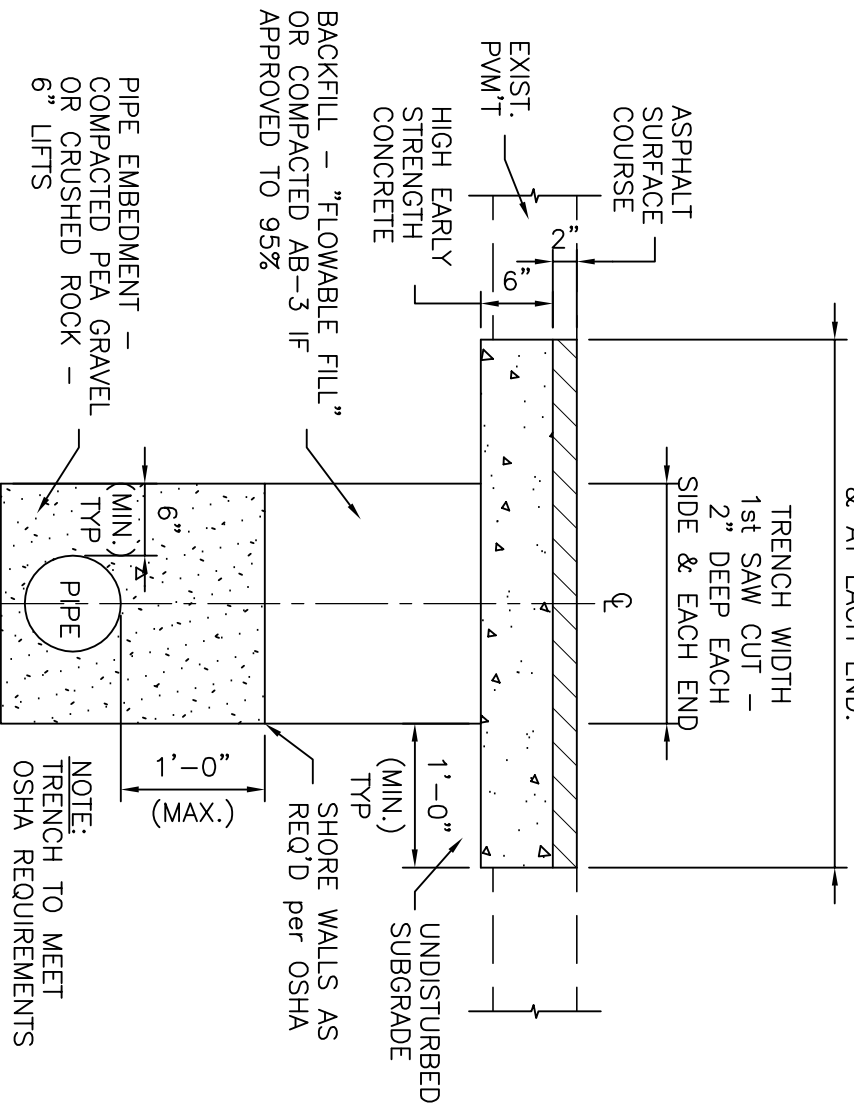

STREET TRENCH

SCALE: 3/4" = 1'-0"

DATE:
 10/06/06
 REVISIONS:
 ▲
 ▲
 ▲
 ▲



CITY OF WESTWOOD
 4700 Rainbow
 Westwood, Kansas 66205
 (913) 432-1550 - PUBLIC WORKS
 (913) 362-1550 - CITY HALL
 "THE BIGGEST LITTLE CITY IN KANSAS"

STANDARD DETAILS

PAGE NO.
C.9
 © 2006