

REVISIONS:

- △
- △
- △
- △

DATE: 10/06/06

STANDARD DETAILS

CITY OF WESTWOOD

4700 Rainbow
 Westwood, Kansas 66205
 (913) 432-1550 - PUBLIC WORKS
 (913) 362-1550 - CITY HALL
 "THE BIGGEST LITTLE CITY IN KANSAS"



SHEET NO.

C101

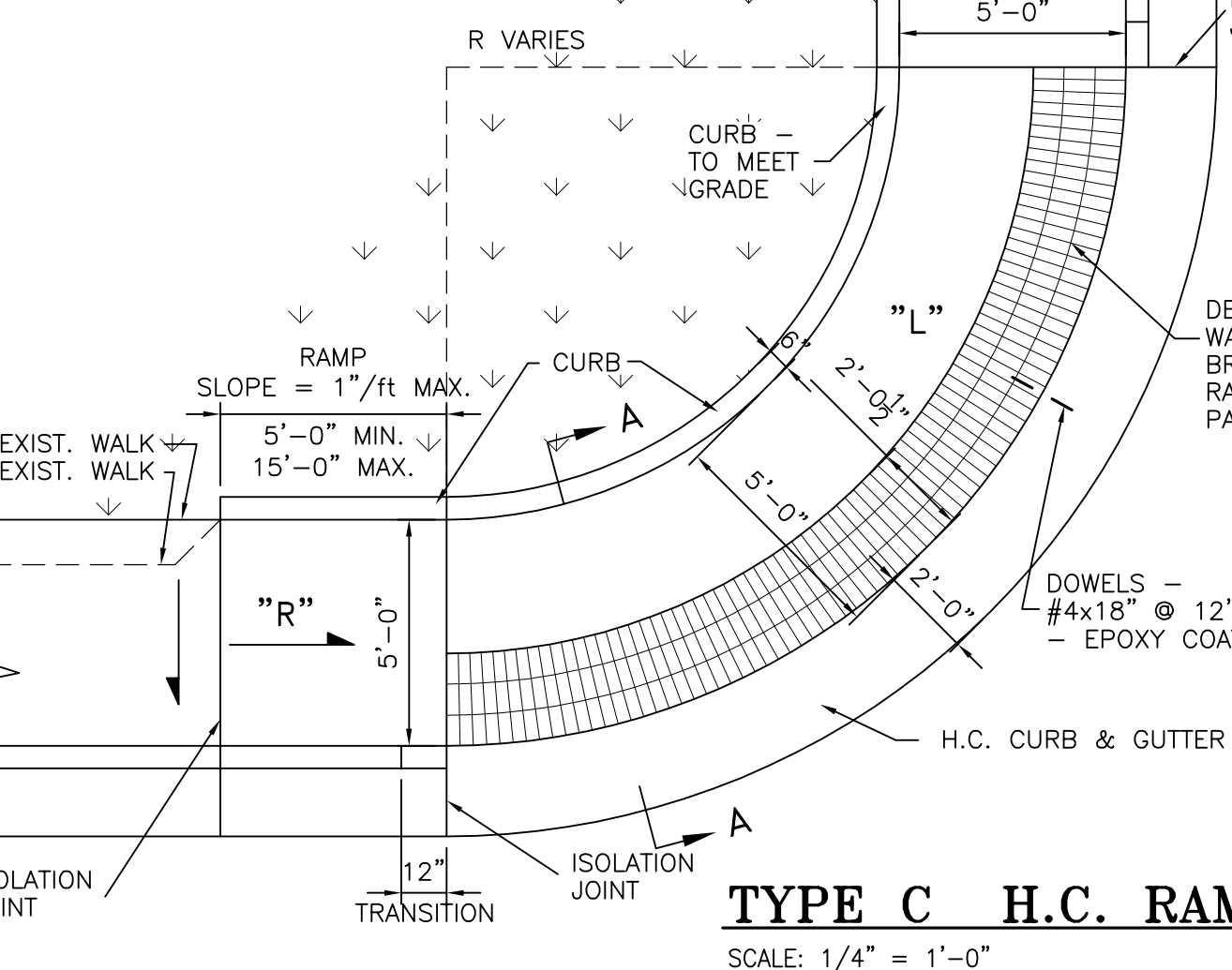
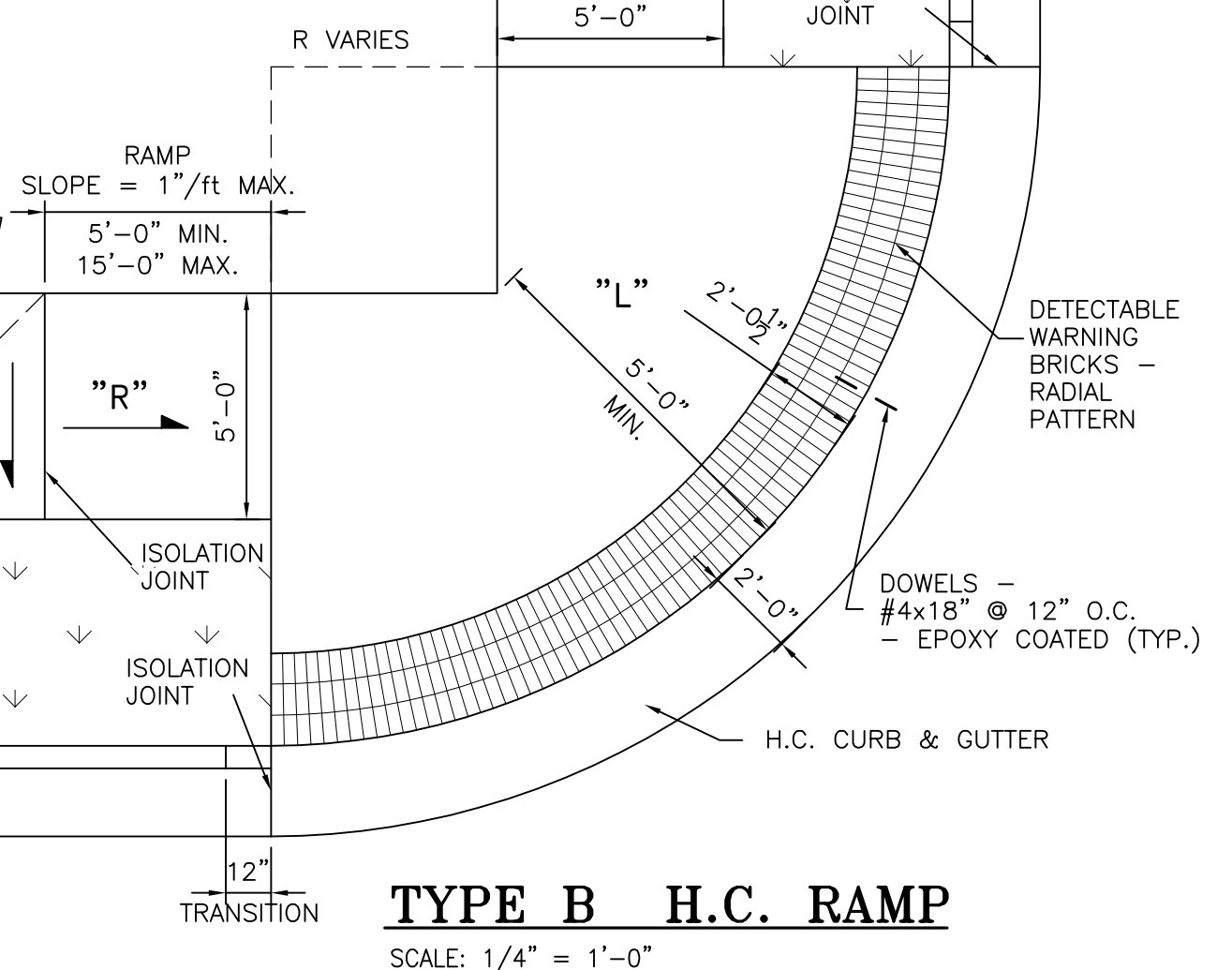
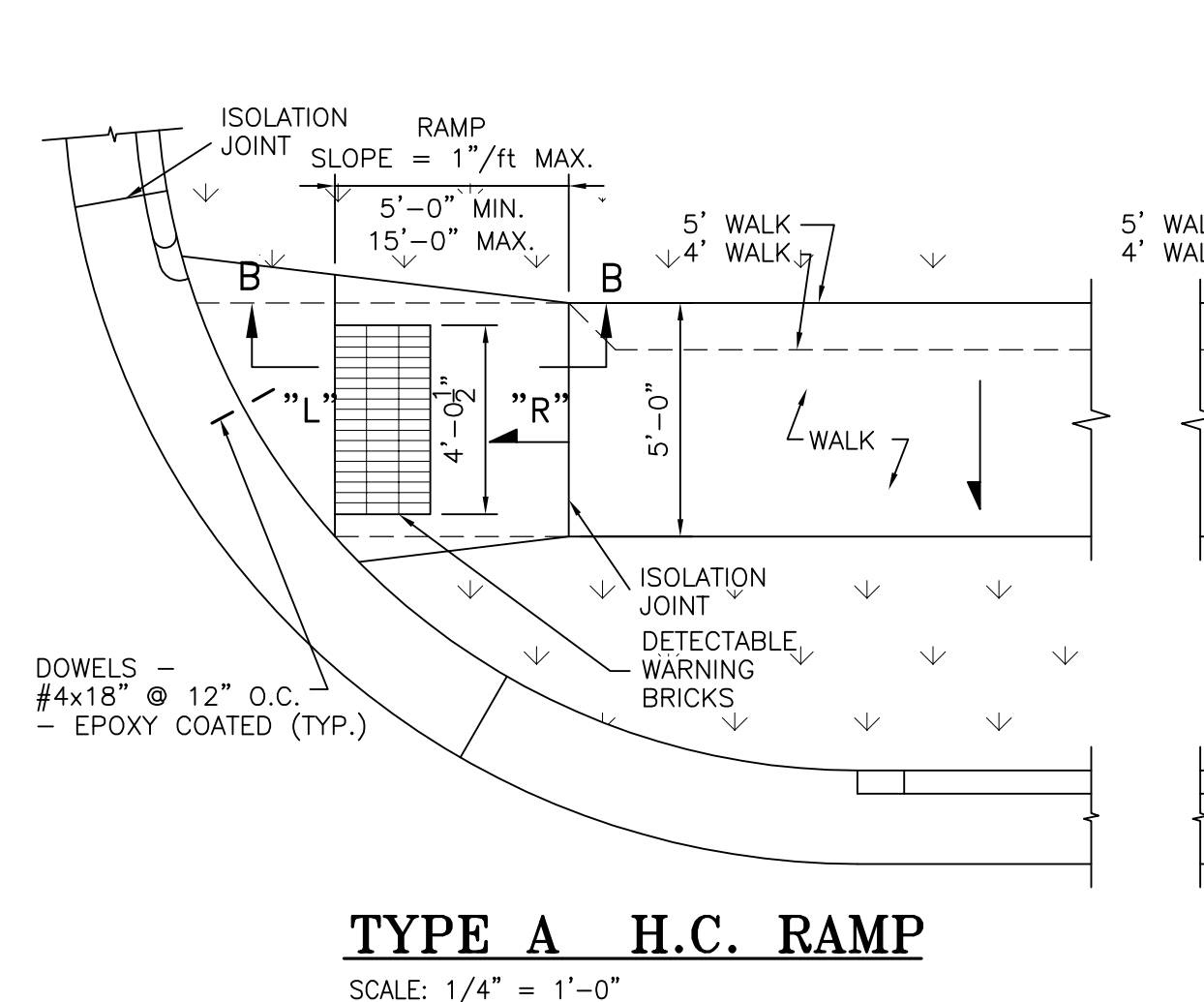
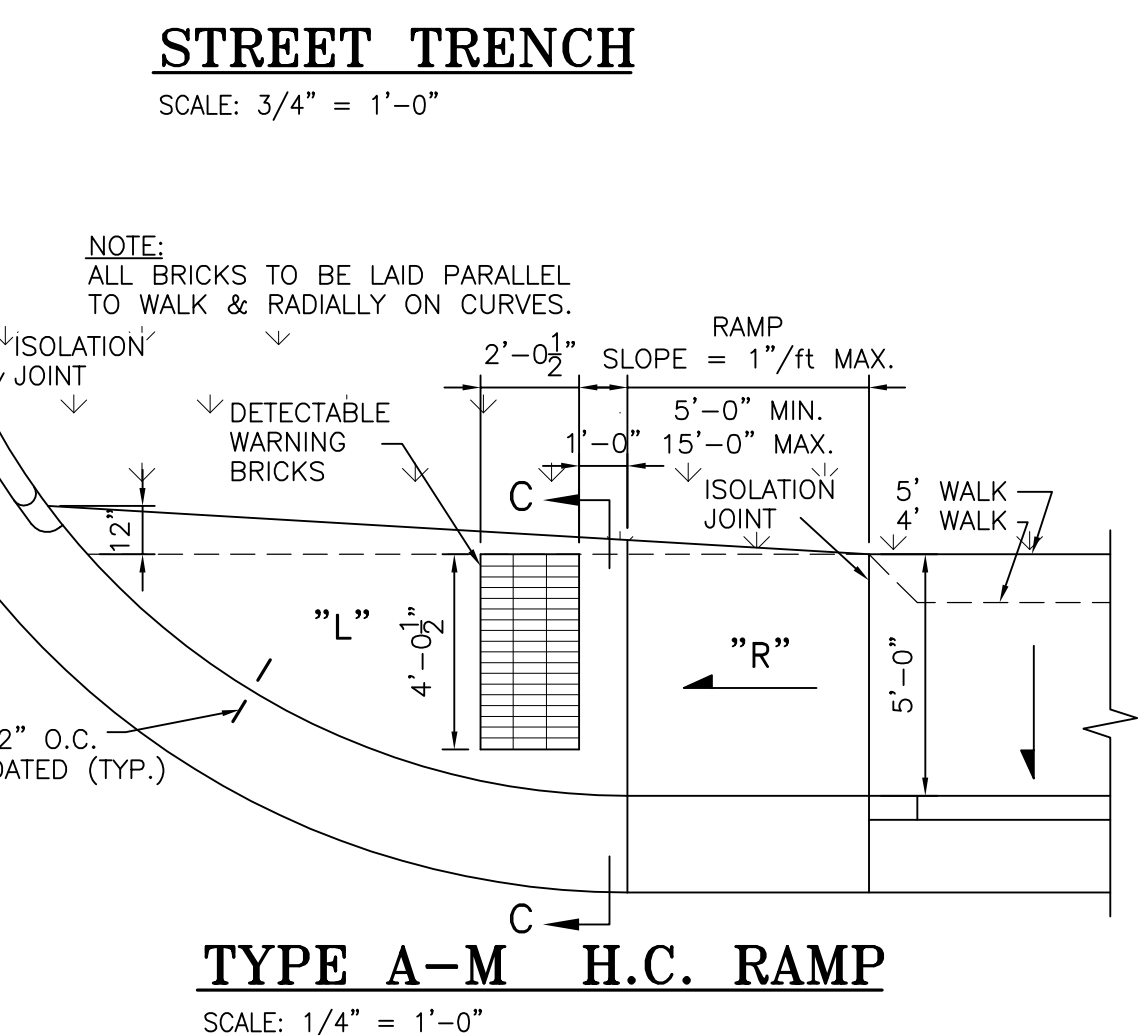
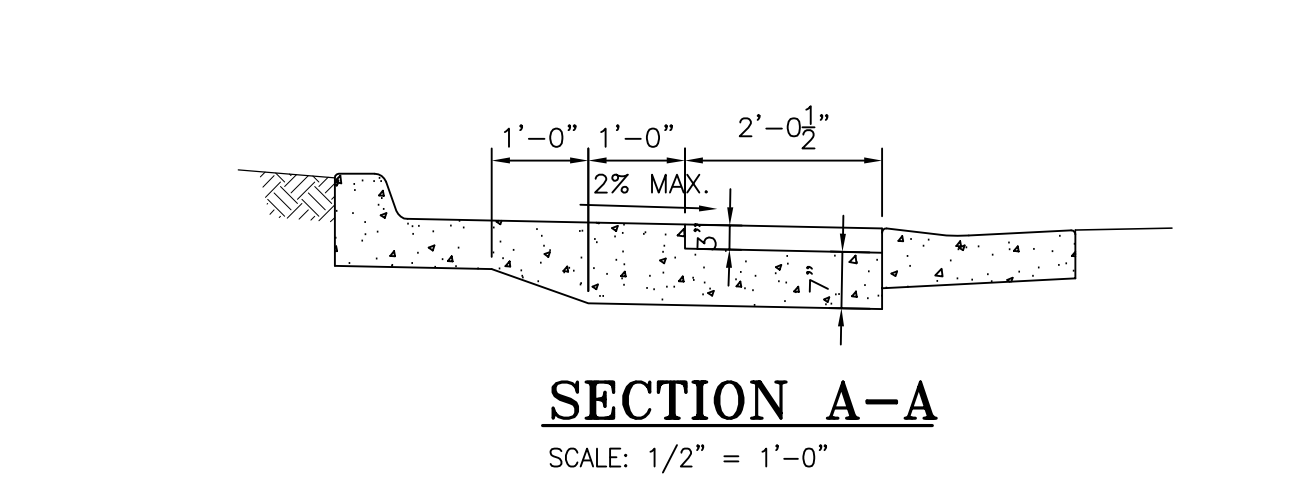
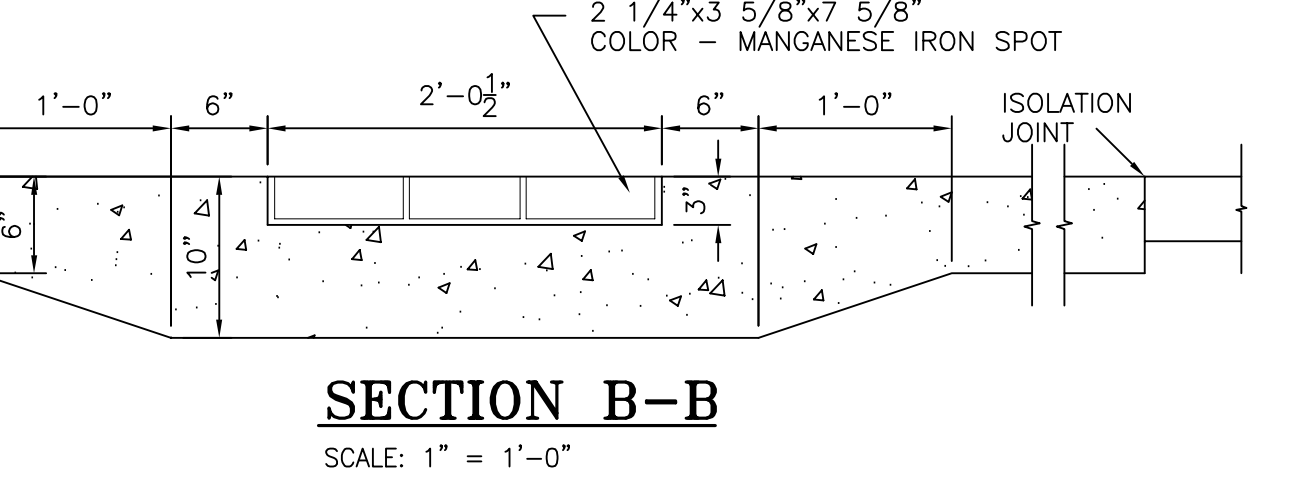
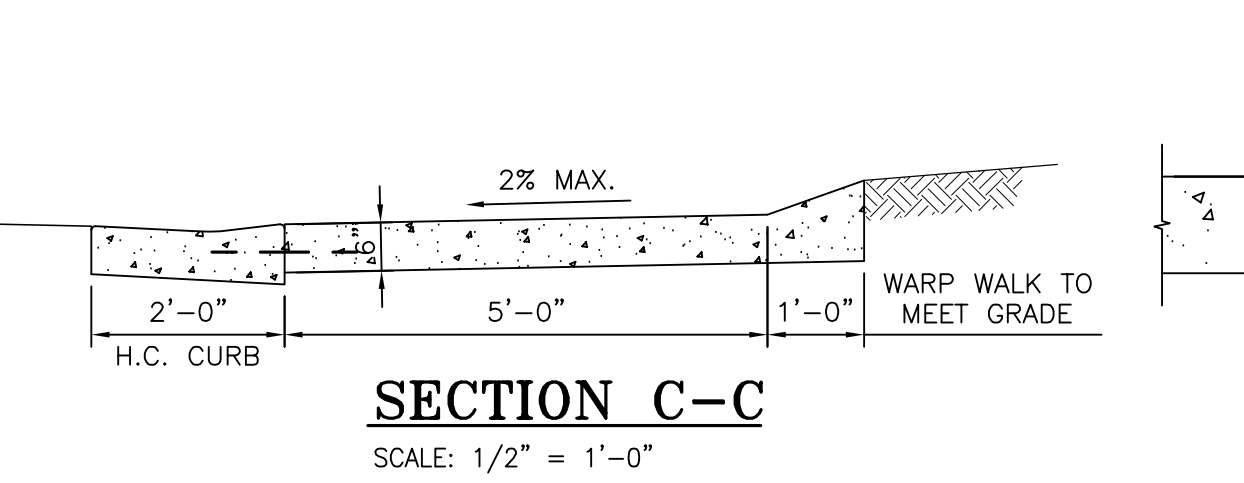
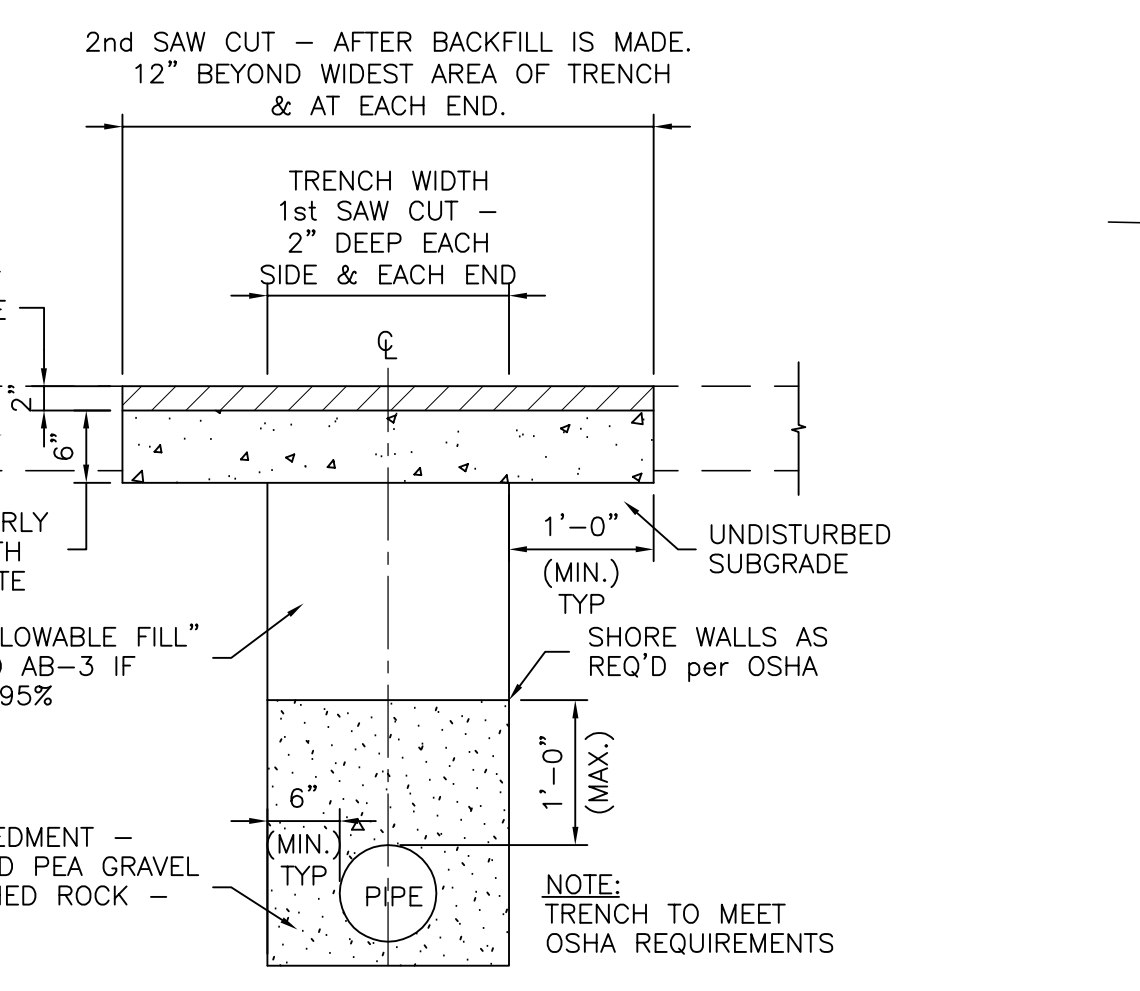
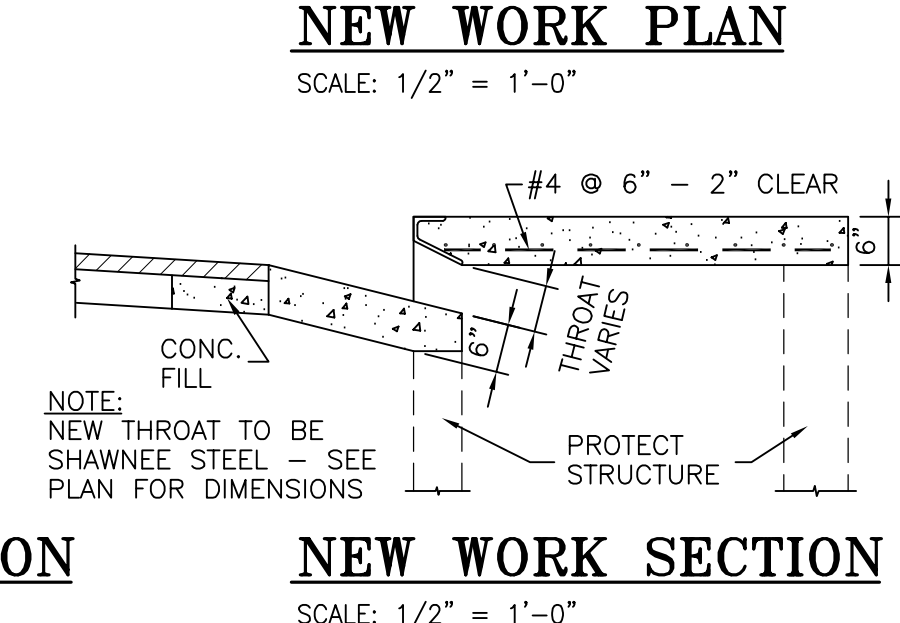
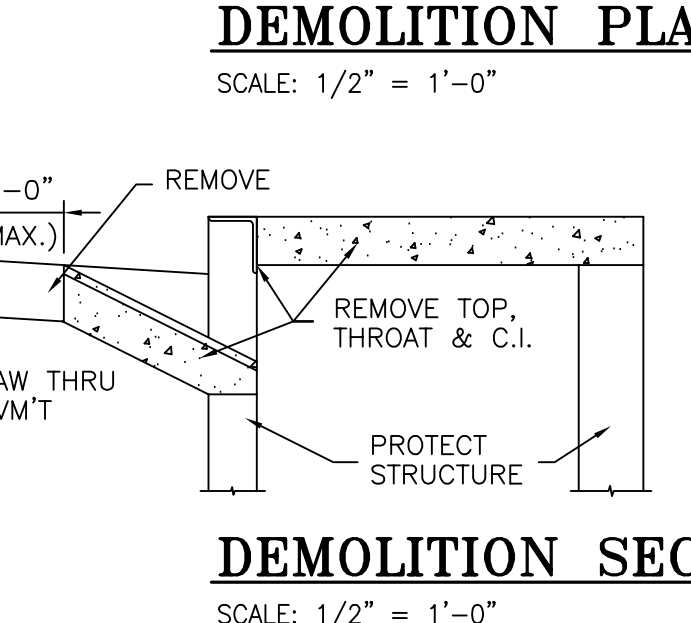
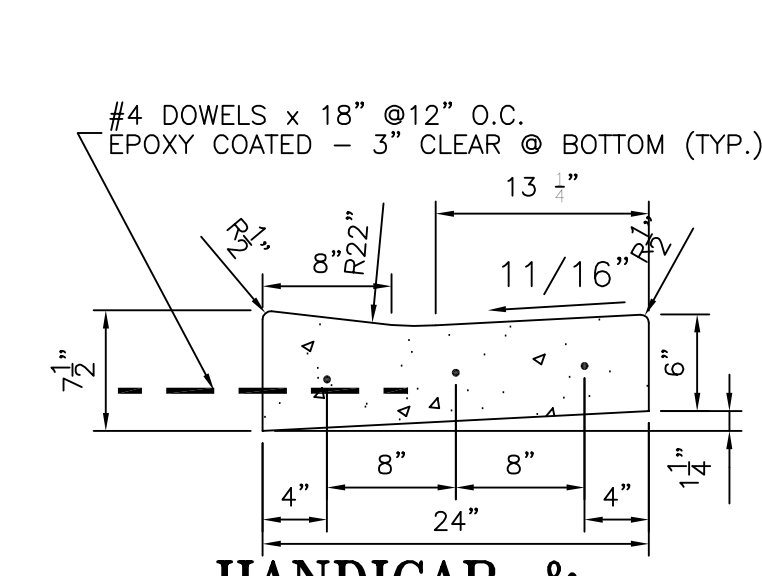
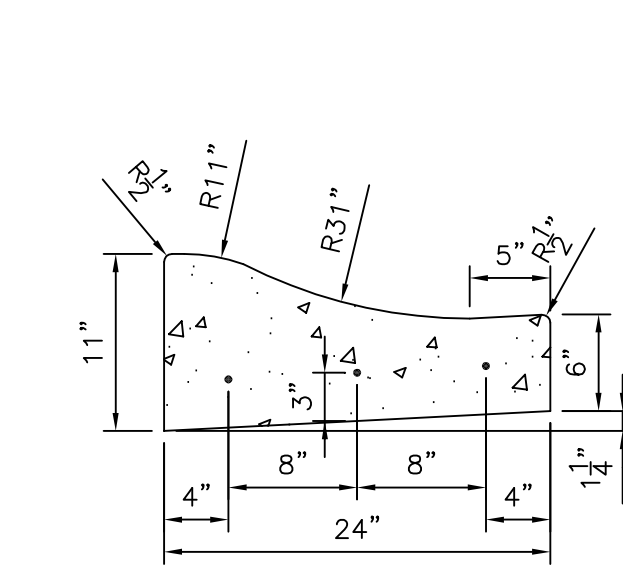
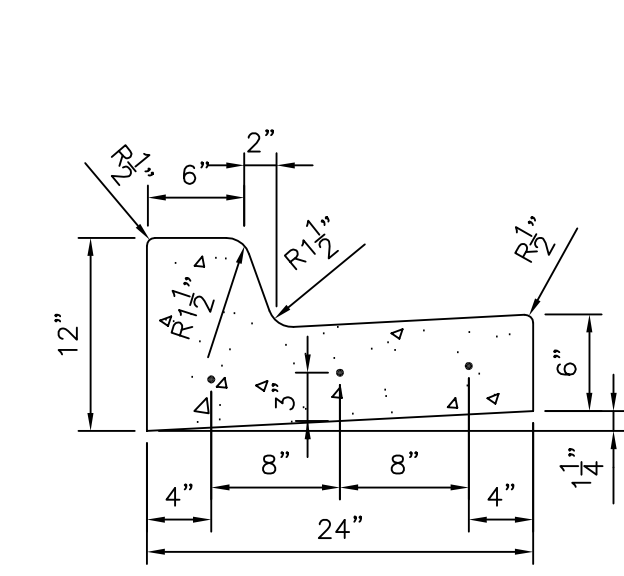
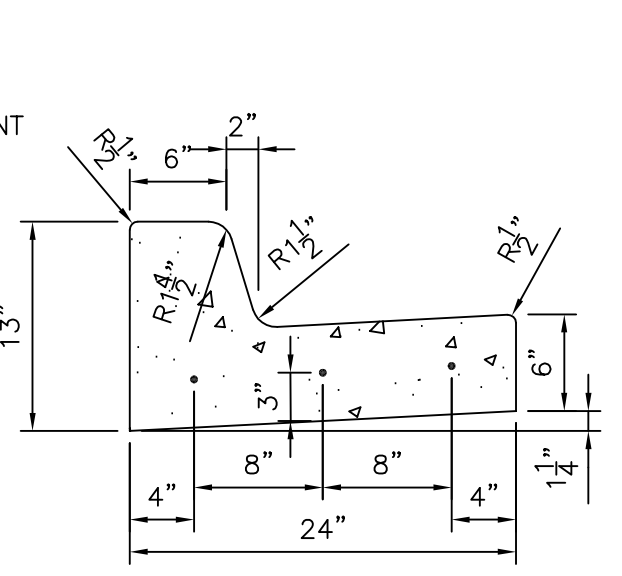
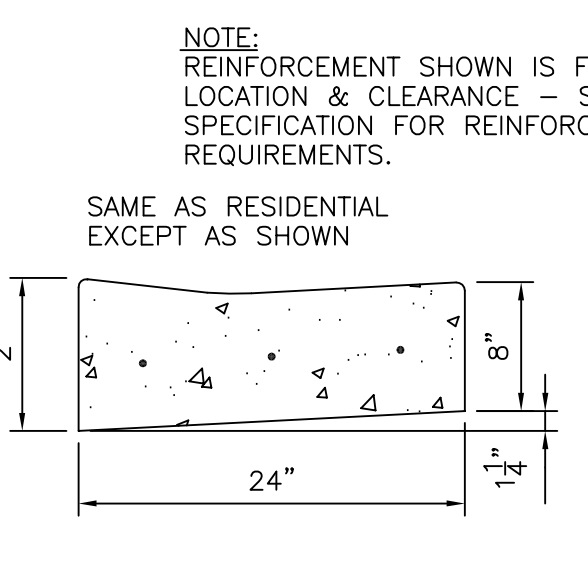
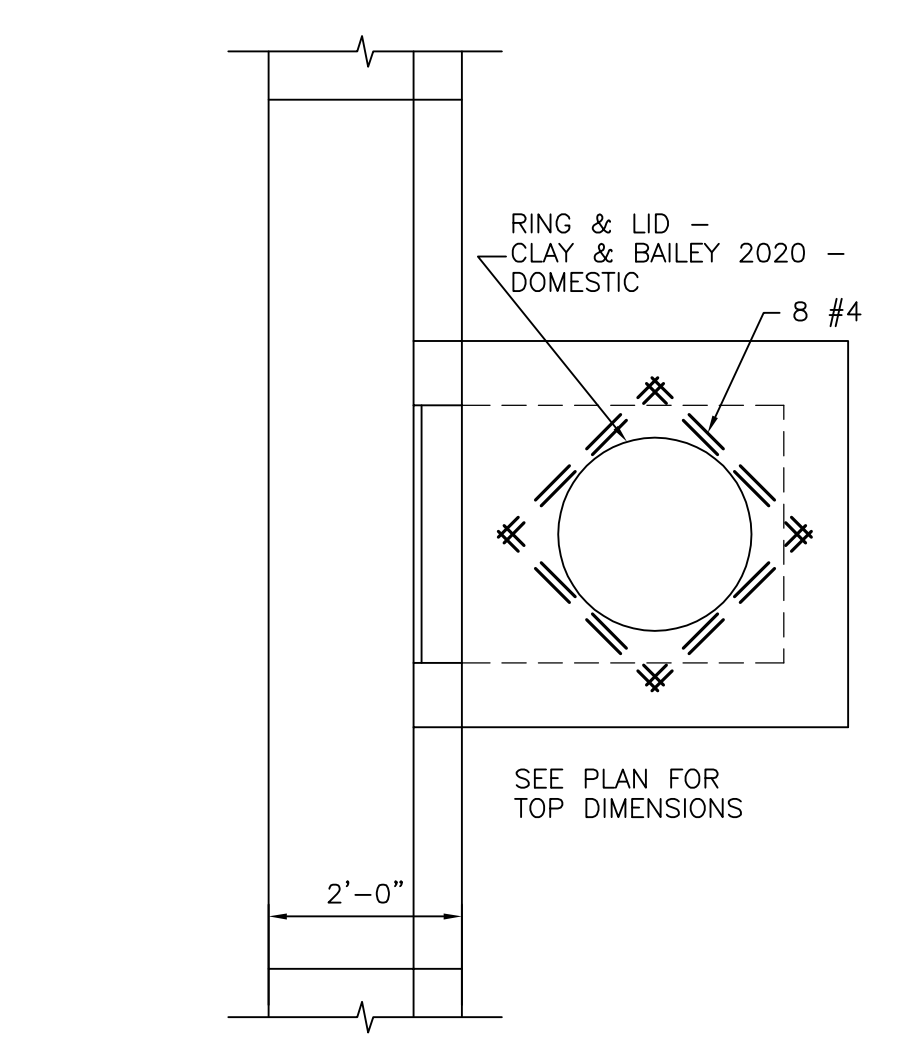
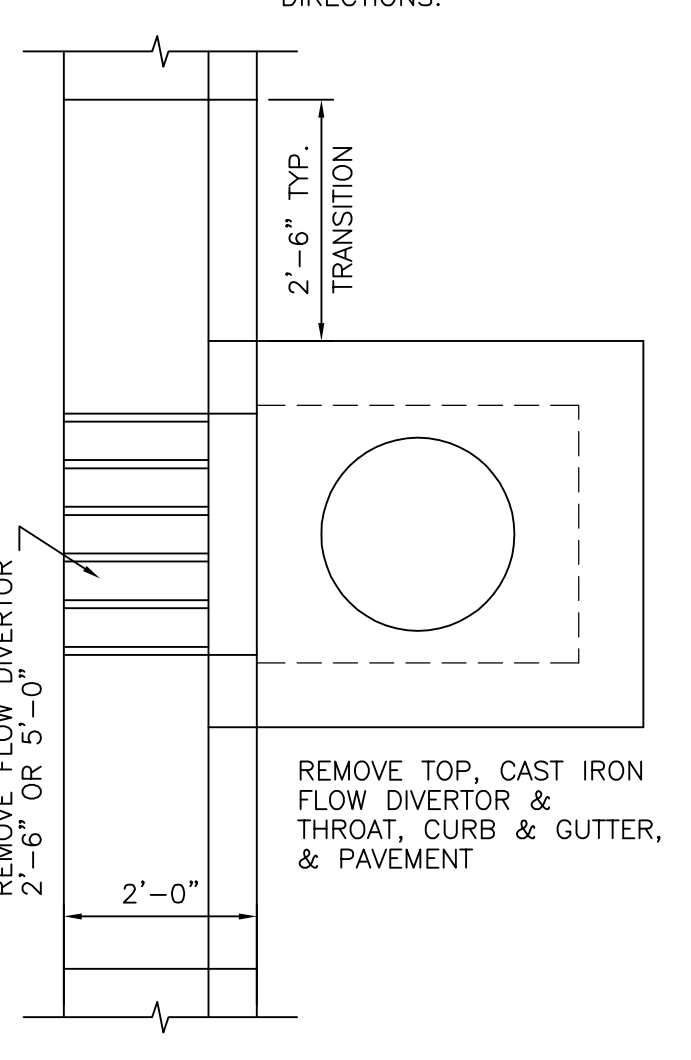
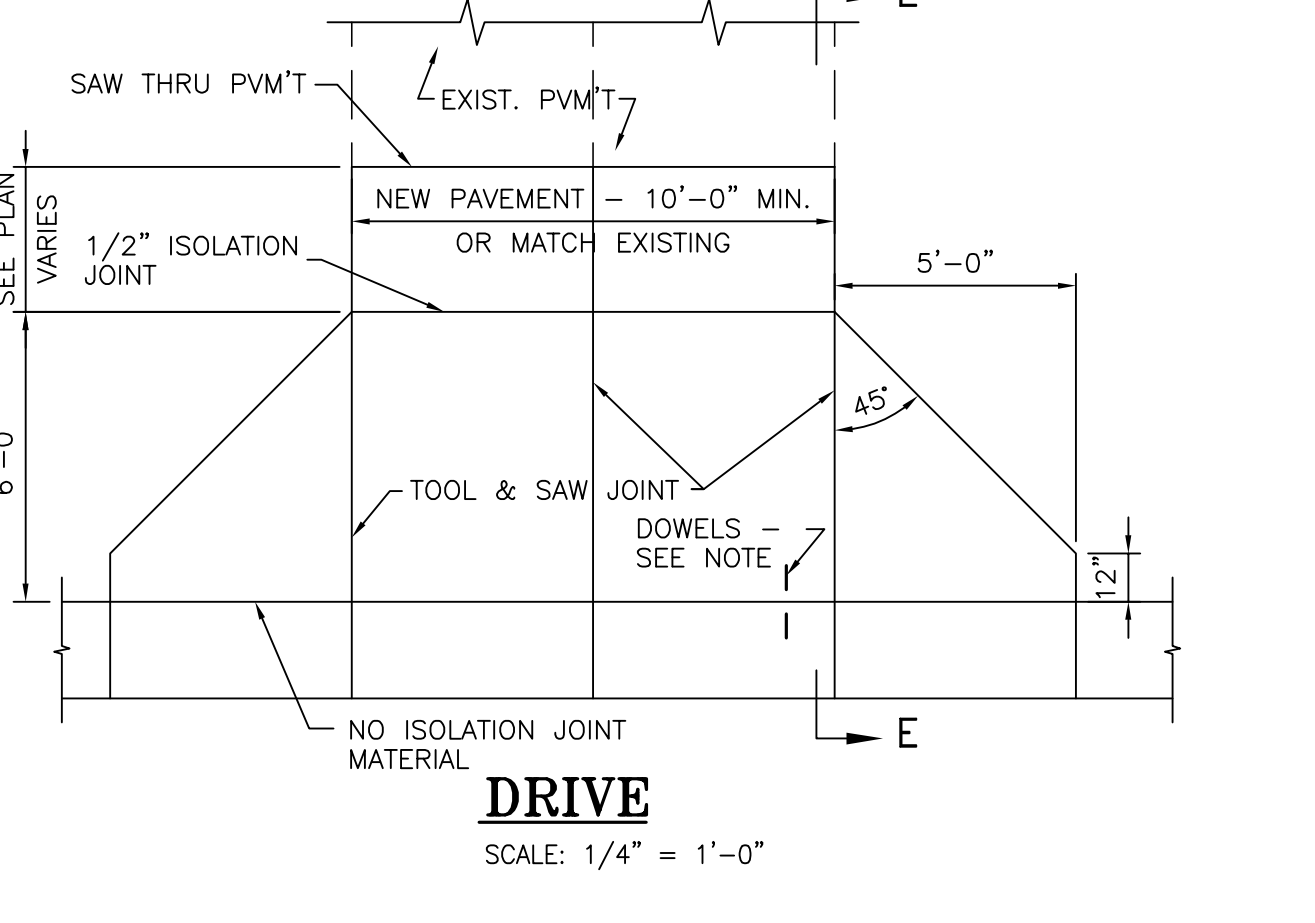
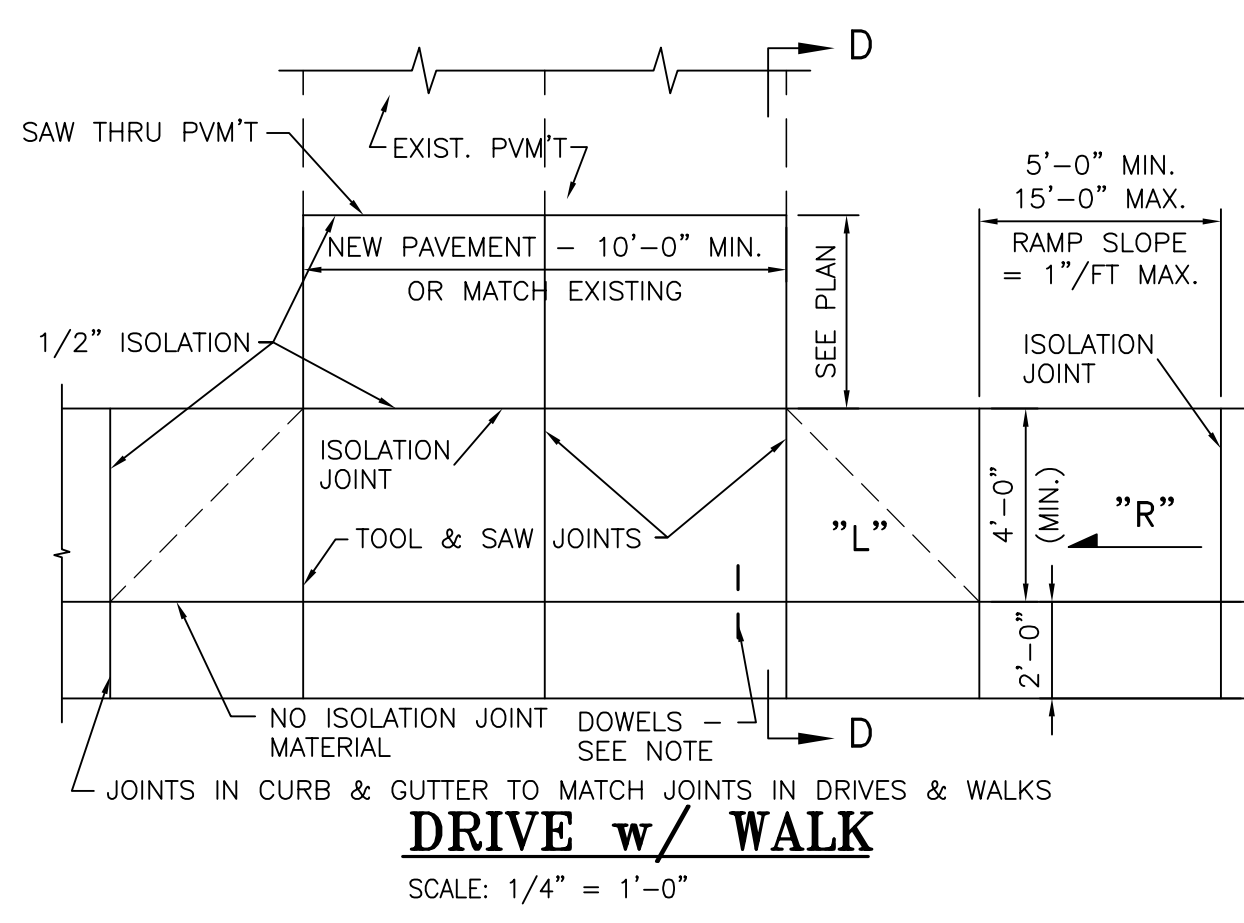
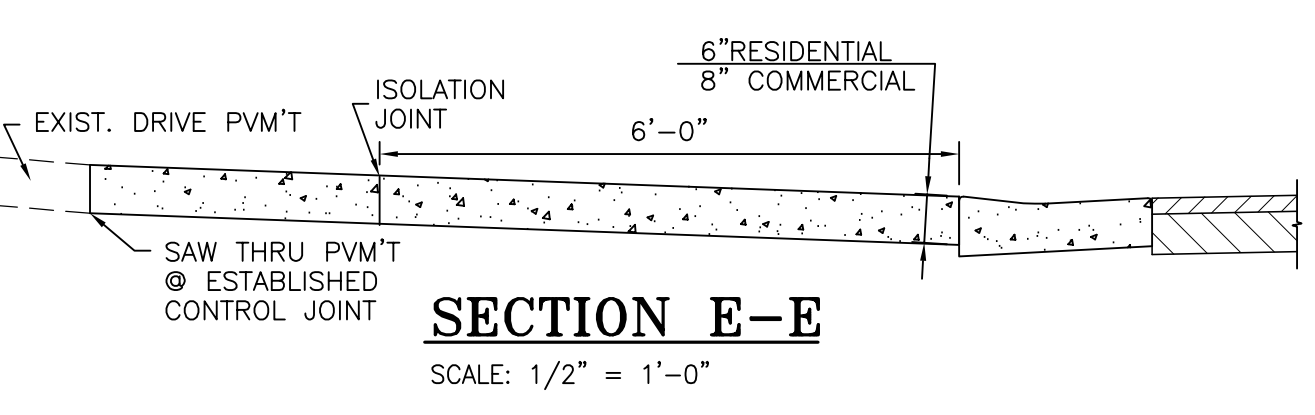
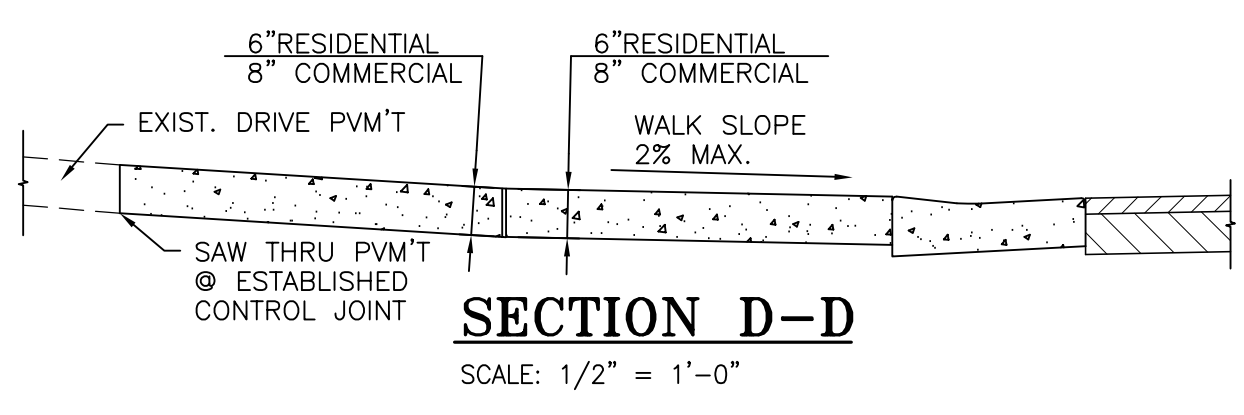
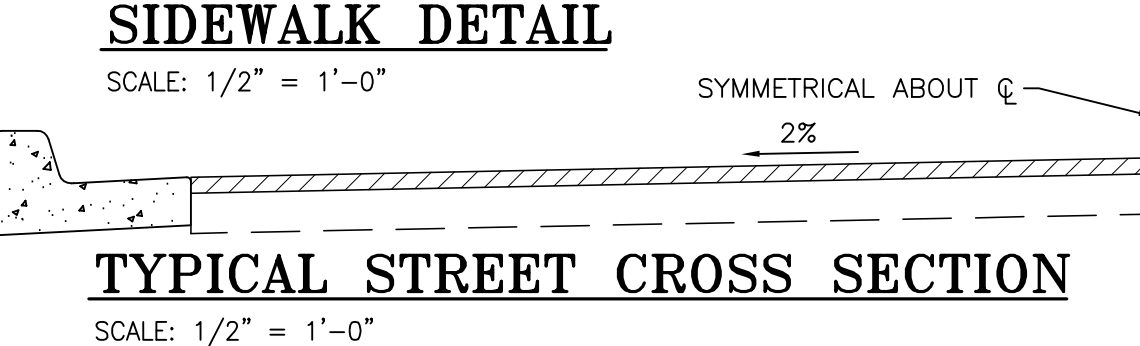
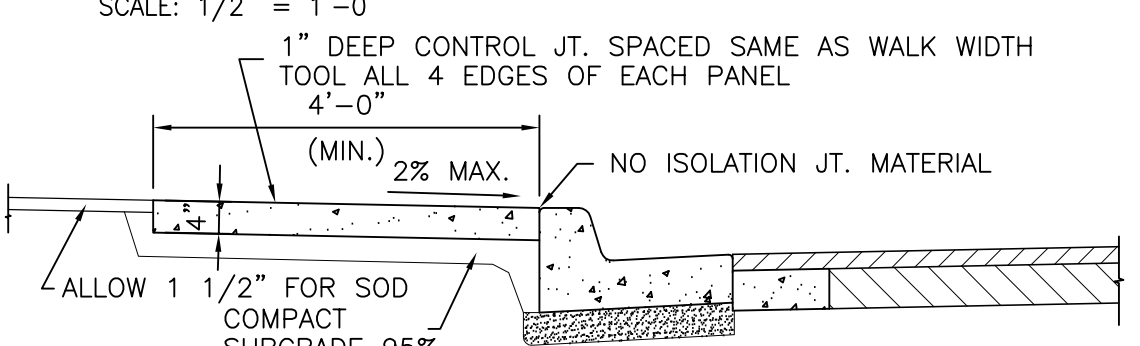
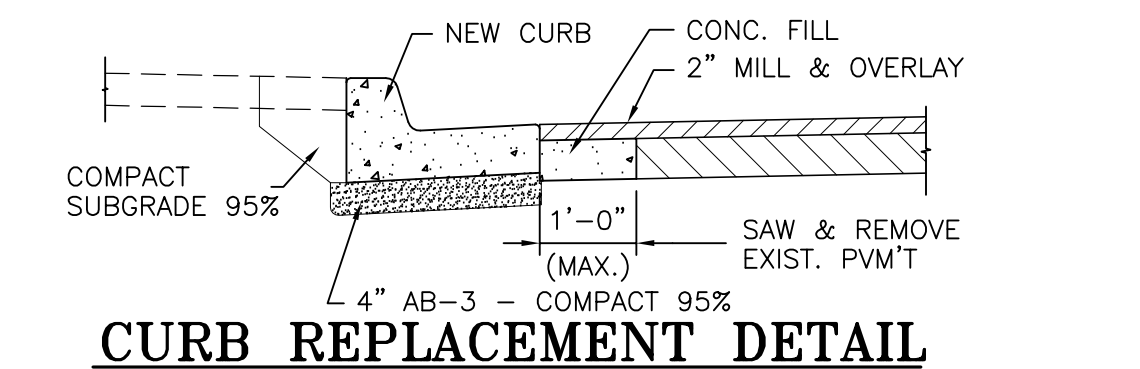

NOTE:
 NO ISOLATION JOINT MATERIAL between CURB & WALK OR LANDING.
 ALL RAMPS TO SLOPE 1"/ft. MAX.
 LENGTH OF RAMP TO BE 5'-0" MIN. 15'-0" MAX.
 CROSS SLOPE OF ALL WALKS AND LANDINGS TO BE 2% MAX. (A.D.A.)
 SLOPE OF ALL LANDINGS TO BE 2% MAX. IN ALL DIRECTIONS.